

DESCRIPTION

- Brass construction
- Thread :G1/2 or NPT1/2

FLOW

- Water usage is limited to these maximum flow rates as indicated by the corresponding product markings
- North America: 1.8 gpm max (6.8L/min) at 60psi
- California: 1.8 gpm max (6.8L/min) at 60psi

CARTRIDGE

- Brass cartridge

STANDARDS

- Certified to CUPC
- Certified to AB1953
- Certified to NSF/ANSI 61
- **ADA**  for lever handle

Specifications

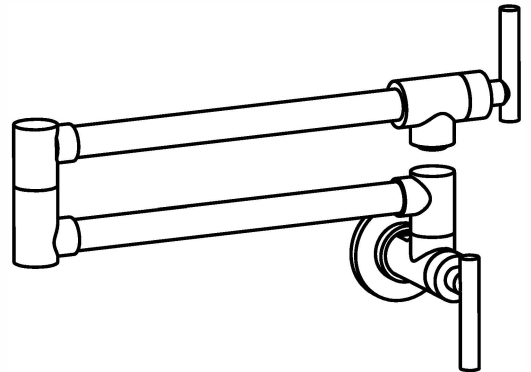

Kitchen Faucet

NOTE: THIS FAUCET IS DESIGNED TO BE INSTALLED THRU 1 HOLE, $\Phi 1\text{-}3/8"$ MIN.

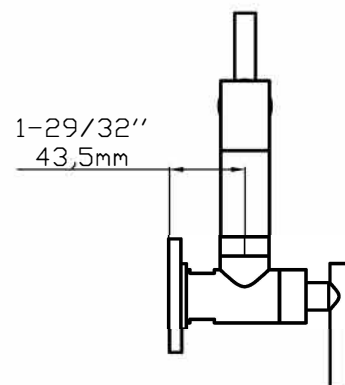
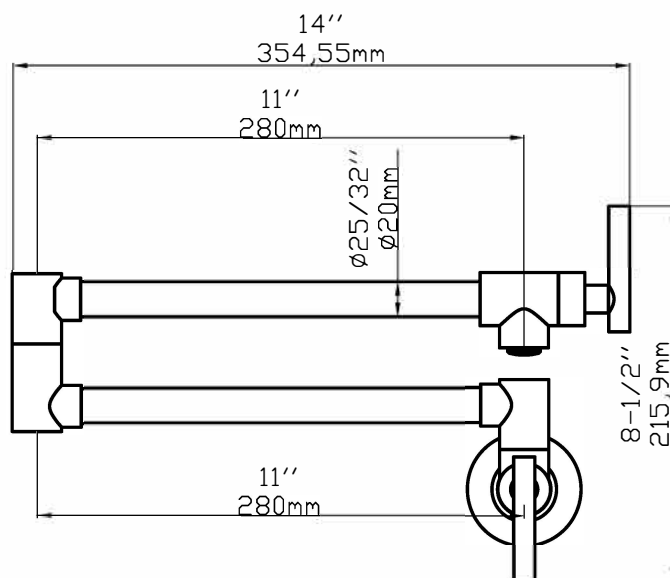

Kitchen Faucet Installation

INSTALLATION MANUAL Tools You Will Need :

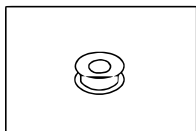

Pipe tape

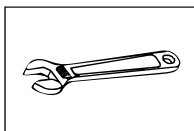

Adjustable wrench

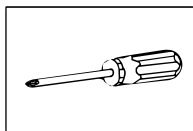

Philips Screwdriver



Notes before installation :

1. Please check that all components are present.
2. Before installation ensure that all feed lines are clear of debris and on/off valve is present.
3. Ensure water pressure is between 20-125 PSI (includes combination of hot and cold feed lines).
4. Pictures in the manual are general in content and may not represent exactly your purchased faucet. If you are having difficulties please contact a professional plumber.
5. If you will be away from home for an extended period you should shut off the main water supply.

Daily maintenance

1. Use a soft cloth and vinegar to remove hard-water spots.
2. Check aerator (if present) regularly for calcium build up are when water stream is not optimum.
3. DO NOT use caustic cleaning products as the use will break down finish and will void the product warranty.
4. Acceptable cleaners include vinegar or mild non-abrasive liquid detergents.
5. If the water pressure appears to be less than optimum remove, inspect, clean or replace aerator.

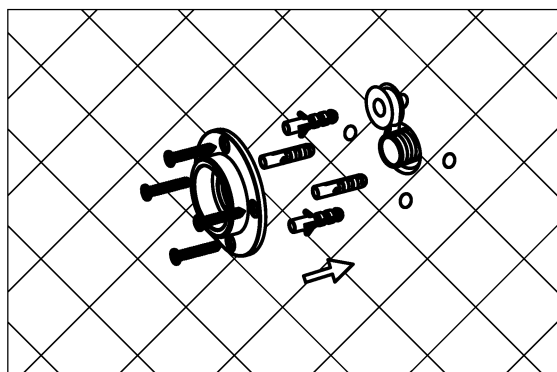

1. Wrap the thread on the pipe with the plumber's tape, then fixed the pipe inside the wall. Fixed the expansion screw into the wall, screw the base on the wall.

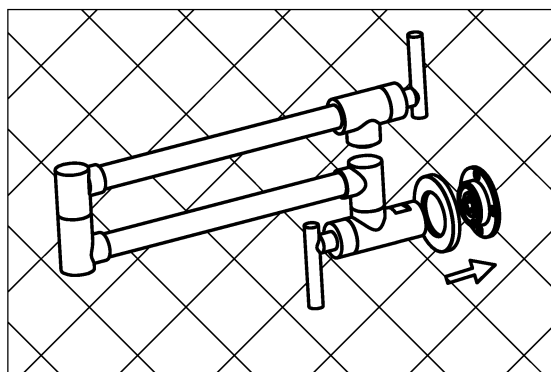

2. The cover hung on the body, then install the faucet into the wall and tighten.

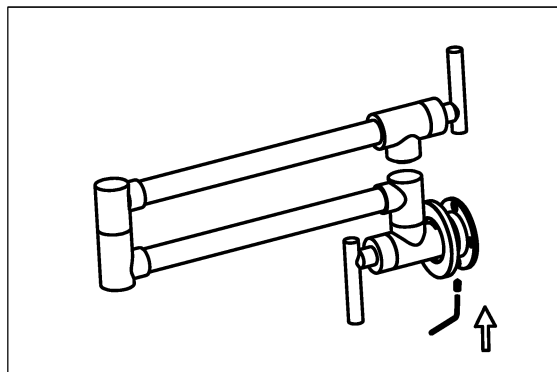

3. Fixed the small screw in the base, fasten the tap and the connecting pipe. Then adjust the cover to the base.

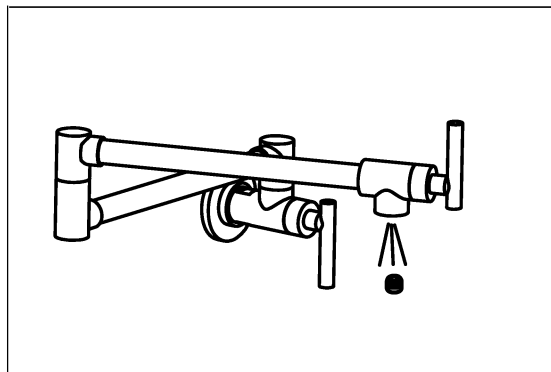

4. Remove the areator, turn on the water, then flush the faucet and check for the leaks. If ok, then turn off the water and install the areator.